

SKETCH PLAN PROPOSED SUBDIVISION OF

PORTION 321 OF THE FARM
DE ONDERSTEPOORT 300-JR
LOCAL AUTHORITY: TSHWANE MUNICIPALITY.

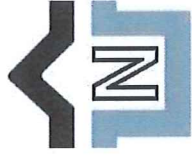

SCALE: 1 : 1 000

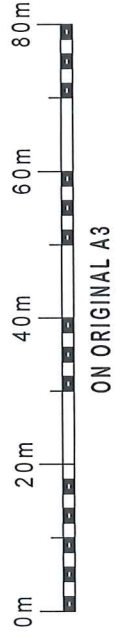

ON ORIGINAL A3



LOCALITY MAP

SCALE : 1 : 25 000

RE/PORTION 92 DE ONDERSTEPOORT 300-JR

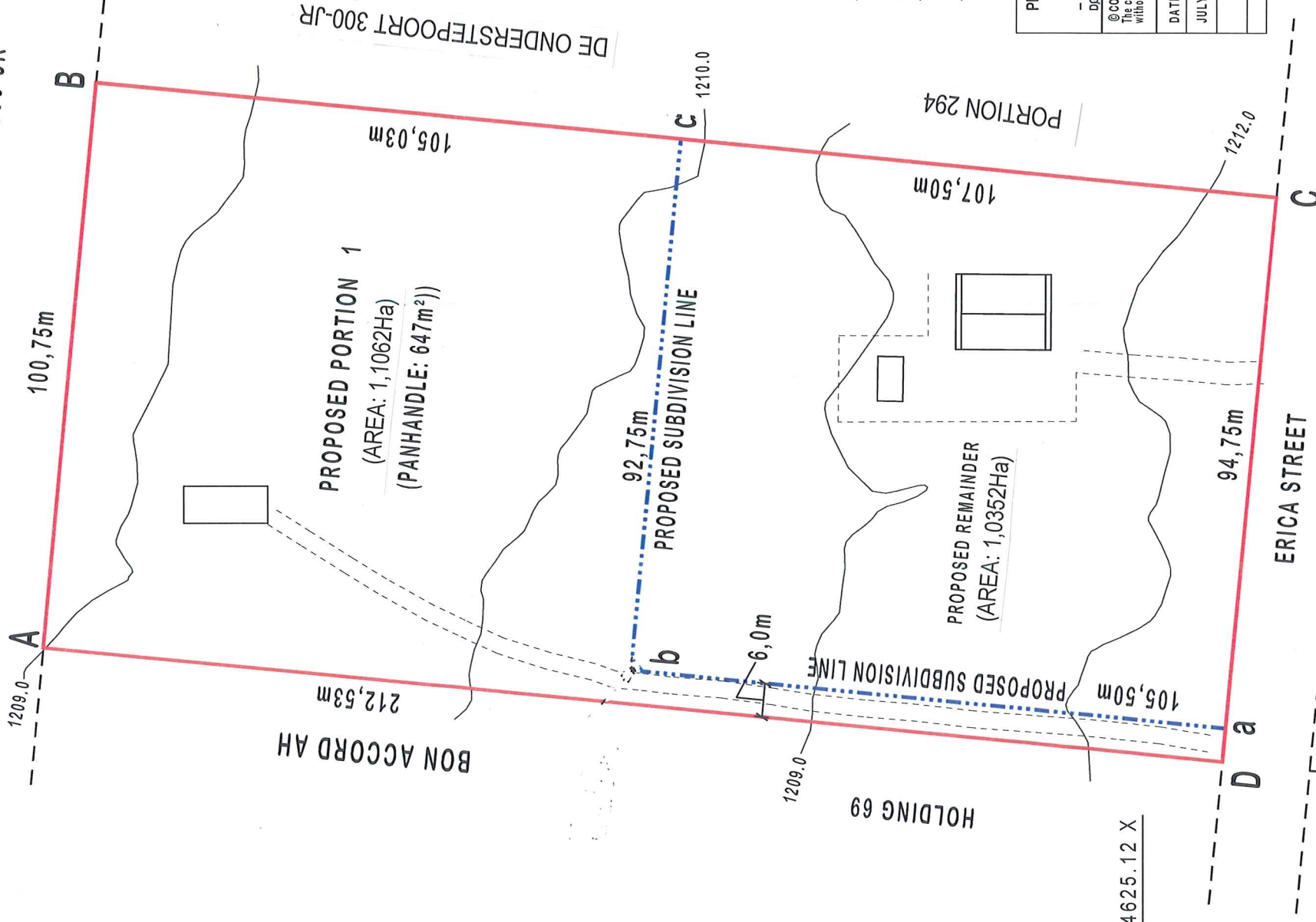

GENERAL NOTES:

- * ALL DIMENSIONS ARE APPROXIMATE AND SUBJECT TO FINAL SURVEY.
- * GEODETIC SYSTEM : LO 28°
- * CONTOURS : TSHWANE METROPOLITAN MUNICIPALITY.
- * CONTOUR INTERVAL : 1,0m
- * PROPERTY AREA : 2,1414Ha
- * OWNER : P.A.J. LOCHNER
- * DEED OF TRANSFER : T60902/2019
- * --- DENOTES THE PROPOSED SUBDIVISION LINES.

PROPOSED SUBDIVISION AREAS:

PROPOSED PORTION 1 (Fig: A-B- -c-b-a-D-A) 1,1062Ha
 PROPOSED REMAINDER (Fig: d-C-a-b-c) 1,0352Ha
 TOTAL AREA OF PORTION 321 2,1414Ha

PLAN NUMBER: 1236	REF: 01
<i>Signature</i>	
DATE: 17/07/2020	
DIGITAL PLAN NO: A23061985	
© COPYRIGHT RESERVED The content of this document is privileged and confidential and may not be disclosed or reproduced without the express authorisation of the author, being "CITYSCOPE TOWN PLANNERS".	
DATE	AMENDMENTS
JULY 2020	SUBMISSION

CityScope Town Planners
15 Years & Beyond

PO Box 72780,
Lynnwood Ridge,
0040

Tel: +27(0)87 755 9850
Fax: +27(0)86 622 6910
www.cityscope.co.za